

# **Bishopstone Station Restoration Project**

**Barbara Mine  
Friends of Bishopstone Station  
Chair**



**Friends of Bishopstone Station**

# To get your project going you need...

Passion...

Perseverance...

Patience ...

Public Support...

People...



# Issues encountered

- Expect the unexpected
- Policies
- Working with a listed Building
- Possible change of status
- Credibility
- Local Planning



# Factoring in sustainability

- Listed buildings limitations
- Is your building fit for today's energy?
- Engage with Railway Heritage
- Research Possibilities



# How do we use the space ?

- Identify the usable area
- Meet regularly
- Community Involvement
- Ideas
- Listen

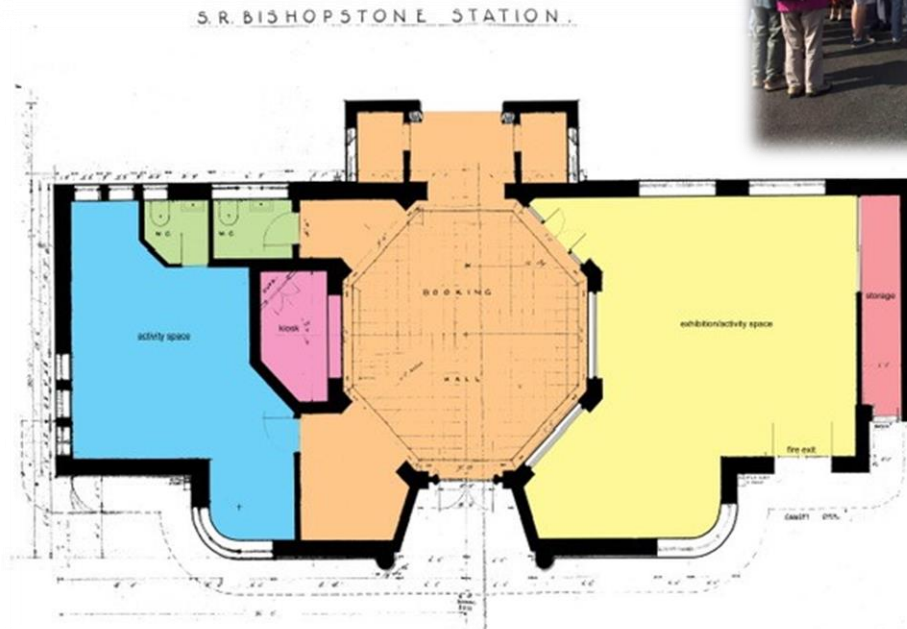



# Running your community space

- Get advice!
- Talk to others who do it
- Work with Network Rail and your Train operator
- Utilities
- Peppercorn rental
- Tripartite lease agreement
- Length of term
- Contact a local solicitor
- Policies



# Top Tips

- Networking and Contacts ...
- Cosy up to your local MP and officials



## Most Import!

- Work with organisations
- Community rail partnerships and Community Rail Network can be invaluable to your project

# Phase 1 completed!





# Bishopstone Station Restoration Project

**Thank you for listening!**  
**Please get in touch if you'd like to know more.**

**[barbaramine@gmail.com](mailto:barbaramine@gmail.com)**

